

Maßbild

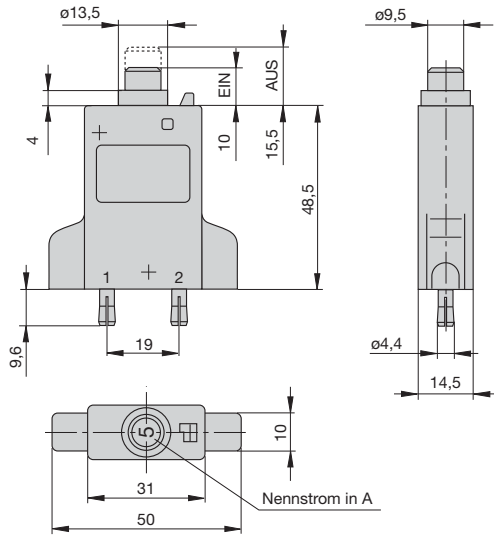

Schaltbild

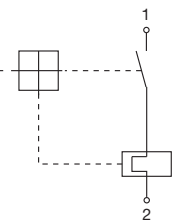

Zeit/Strom-Kennlinie

(Gesamtabschaltzeit bei Nennspannung)
 Umgebungstemperatur 23 °C

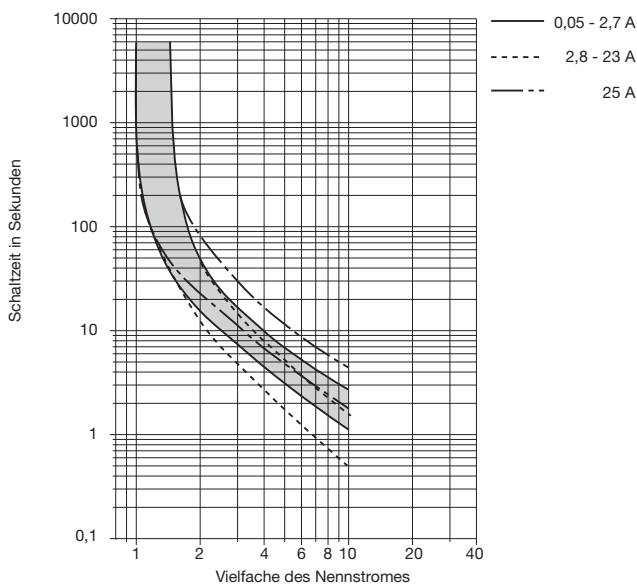

Die Zeit/Strom-Kennlinien sind abhängig von den Umgebungstemperaturen. Um eine vorzeitige oder späte Abschaltung zu vermeiden, muss der Schutzschalterennennstrom mit einem Temperaturfaktor multipliziert werden (siehe auch Kapitel 9 – Technische Informationen).

Umgebungstemperatur °C	-20	-10	0	23	40	50	60
Temperaturfaktor	0,76	0,84	0,92	1	1,08	1,16	1,24

Zubehör

Best.-Nr. 10R-K10
 (bis 20 A dauernd belastbar)

Best.-Nr. 10R-P10
 (bis 16 A dauernd belastbar)

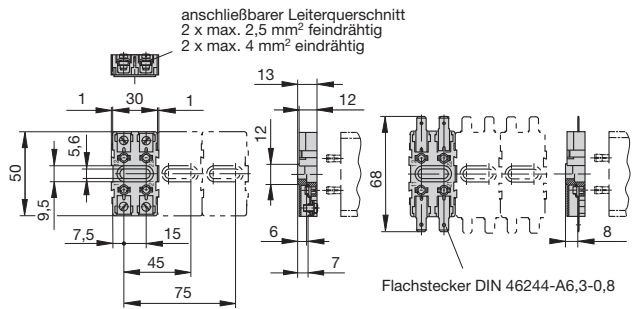

Best.-Nr. 10R-A10
 (bis 16 A dauernd belastbar)

Verbindungsschienen für Klemmbretter 10...:
Best.-Nr. Y 301 166 02 (2fach)

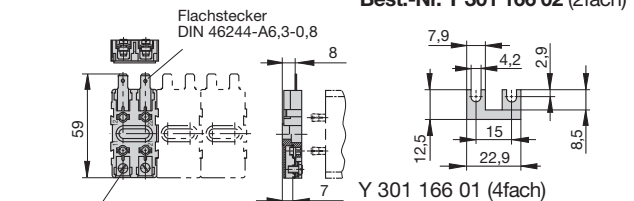

anschießbarer Leiterquerschnitt
 2 x max. 2,5 mm² feindrähtig
 2 x max. 4 mm² eindrähtig

Stecksocket Best.-Nr. 16
 (bis 16 A belastbar)

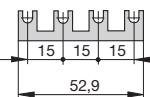

Dicke = 0,8 mm

Adapter Best.-Nr. X 200 409 01
 zur nachträglichen Tragschienenmontage nach EN 50035-G32 (G-Schiene) für Stecksocket 16 auf Anfrage

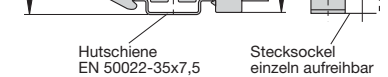

Hutschiene EN 50022-35x7,5

Stecksocket einzeln aufreibbar

Blindstecker Best.-Nr. Y 301 477 01
 für 10R-P10/K10

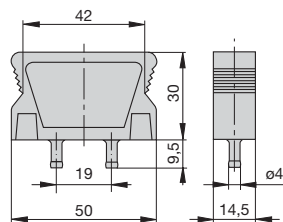

Befestigungswinkel Best.-Nr. X 200 800 01
 für 10R, 10F auf Tragschiene n. DIN EN 50 035-G32

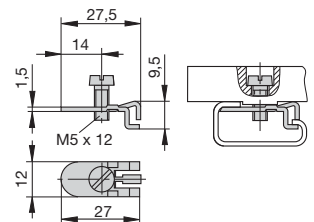

Verbindungsketten -P10

- Best.-Nr. X 210 588 01/ 1,5 mm², braun
- Best.-Nr. X 210 588 02/ 2,5 mm², schwarz
- Best.-Nr. X 210 588 03/ 2,5 mm², rot
- Best.-Nr. X 210 588 04/ 2,5 mm², blau

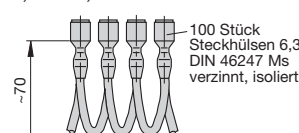

Verbindungsketten -K10

- Best.-Nr. X 210 589 01/ 2,5 mm², schwarz
- Best.-Nr. X 210 589 02/ 1,5 mm², braun

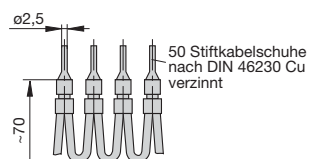

1,5 mm²: bis 13 A dauernd belastbar
 2,5 mm²: bis 20 A dauernd belastbar

Dimensions

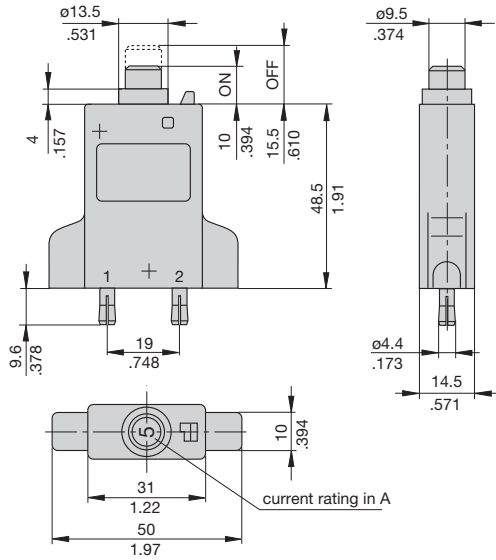

Internal connection diagram

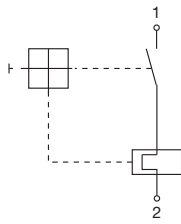

Typical time/current characteristics at +23 °C/+73.4 °F

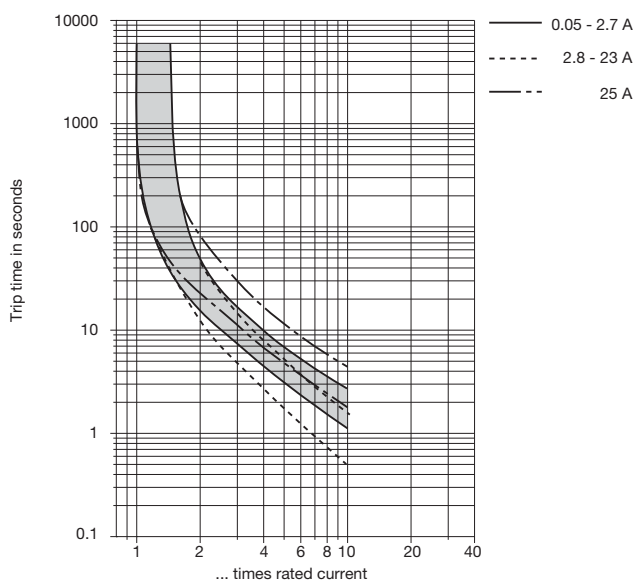

The time/current characteristic curve depends on the ambient temperature prevailing. In order to eliminate nuisance tripping, please multiply the circuit breaker current ratings by the derating factor shown below. See also section 9 – Technical information.

Ambient temperature °F	-4	+14	+32	+73.4	+104	+122	+140
°C	-20	-10	0	+23	+40	+50	+60
Derating factor	0.76	0.84	0.92	1	1.08	1.16	1.24

Accessories

Sockets 10R-K10

wire cross sectional areas
 2 x max. 2.5 mm² AWG 14 stranded
 2 x max. 4 mm² AWG 12 solid

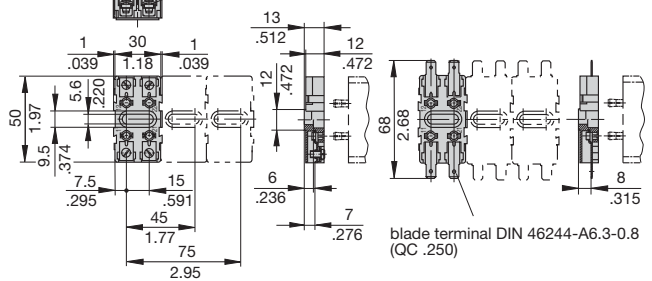

10R-P10

blade terminal DIN 46244-A6.3-0.8 (QC .250)

10R-A10

blade terminal DIN 46244-A6.3-0.8 (QC .250)

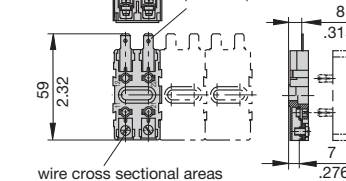

wire cross sectional areas
 2 x max. 2.5 mm² AWG 14 stranded
 2 x max. 4 mm² AWG 12 solid

Bus bar for sockets 10... Y 301 166 02 (2 way)

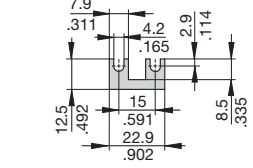

Y 301 166 01 (4 way)

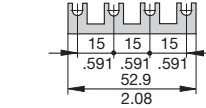

Socket 16

(up to 16 A max. load)

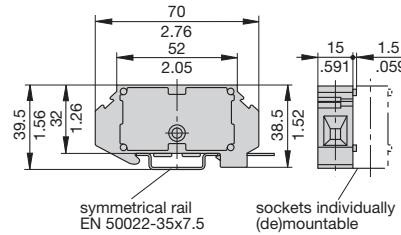

thickness = 0.8 mm
 .031 in.

Adapter for EN rail 50035-G32 (specified as a separate item)
X 200 409 01
 for socket 16 available on request

Blanking plug

Y 301 477 01
 for sockets 10R-P10/K10

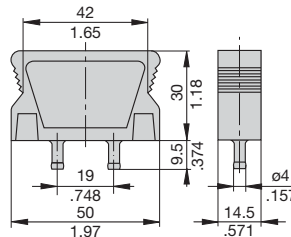

Terminal for mounting rack

X 200 800 01
 for sockets 10R, 10F on EN rail 50 035-G32

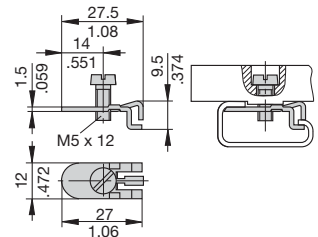

Connector bus links -P10

X 210 588 01/
 1.5 mm² (AWG 16) (brown)
 X 210 588 02/
 2.5 mm² (AWG 14) (black)
 X 210 588 03/
 2.5 mm² (AWG 14) (red)
 X 210 588 04/
 2.5 mm² (AWG 14) (blue)

Connector bus links -K10

X 210 589 01/
 2.5 mm² (AWG 14) (black)
 X 210 589 02/
 1.5 mm² (AWG 16) (brown)

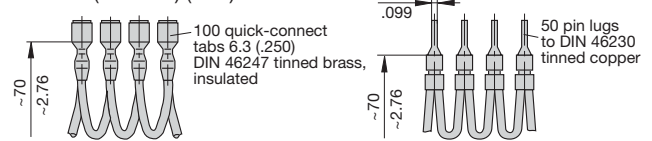

1.5 mm² - up to 13 A max. load
 2.5 mm² - up to 20 A max. load

This is a metric design and millimeter dimensions take precedence (mm/inch)